

730.000 €

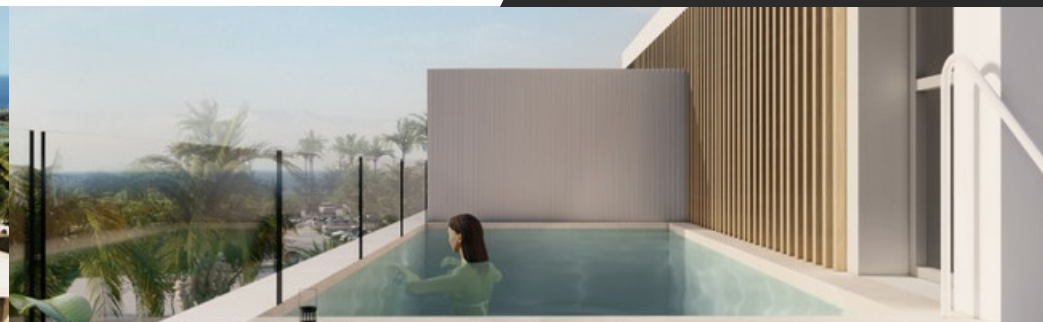

## Description:

New Development: Prices from 730,000 € to 845,500 €. [Beds: 4 - 4] [Baths: 3 - 4] [Built size: 179.00 m2 - 218.00 m2]

### THE DEVELOPMENT

For the realisation of this exclusive new boutique development of 10 attached villas, a plot with wonderful views of the sea, the golf course and the mountains has been chosen.

### ARCHITECTURE AND DESIGN

The architecture seeks maximum expressiveness by combining three materials. The white facade brings us closer to an environment of sun and beach, combined with the dark gray stone, they generate spaces of greater depth, the vertical elements of aluminum imitation wood will give that tone of warmth that can be seen in the images.

Materials with very low maintenance that make these facades not only an impressive vision but also consistent with the environment.

### QUALITIES

When the quality of the home is not just aesthetics, it is committed to using top brand materials, carrying out construction work with care and

## Characteristics:

### Setting:

Close To Golf, Close To Sea

### Orientation:

South East

### Pool:

Private

### Climate Control:

Hot A/C, Cold A/C, U/F/H Bathrooms

### Views:

Mountain, Golf, Beach, Garden

### Features:

Fitted Wardrobes, Private Terrace, Solarium, Ensuite Bathroom, Double Glazing

## Location: ESTEPONA

Type of the property	Townhouse
Bedrooms	4
Bathrooms	3
Built	179m <sup>2</sup>
Terrace	28m <sup>2</sup>
Plot area	129m <sup>2</sup>